

Grand Concourse Signage and Coat Check Service Package

Material Specifications

Deliverables due to RSNA by August 25

- Company Name for recognition in the RSNA 2024 Meeting Guide
- Logo files for entrance unit to the Grand Concourse Coat Check location: High-res PDFX/4 file type requested; AI with PDF content or EPS files with embedded links and outlined fonts also accepted
- Logo file for baggage/coat check tickets: full color (CMYK) PDF file (additional detail below)



Baggage/coat check ticket

Logo should be provided as a full color (CMYK) PDF file. Screenshot to the right shows a sample baggage/coat check ticket from a prior year. RSNA 2024 design is subject to change. Booth number will be added to the ticket below the sponsor logo and should be confirmed when the sponsor submits the logo file.

File Submission

- Email company name, logo files, and confirmation of optional giveaway item to sponsors@rsna.org.
- Reach out to the RSNA sponsorship team with any questions at the email address noted above.



Additional deliverables detailed on the following pages

Deliverables due to Freeman by October 16

Custom artwork for stair risers in the Grand Ballroom Lobby

Measurements for each set of stairs (west, center and east) are detailed on the following pages.

For optimal readability use a heavy-weight font and position words on a single stair.

For artwork requirements, see the Freeman Graphics Artwork Guidelines, available for download on this [page](#).

Additional photos of the Grand Ballroom Lobby stairs are also available on the page linked above.



File Submission

- Upload artwork files to Freeman's Box folder. Access to the folder will be emailed to you in August.
- When uploading your files, please supply the creative file name for west, center and east stairs.
- Reach out to the RSNA sponsorship team with any questions at sponsors@rsna.org.

Grand Ballroom Lobby with stairs highlighted

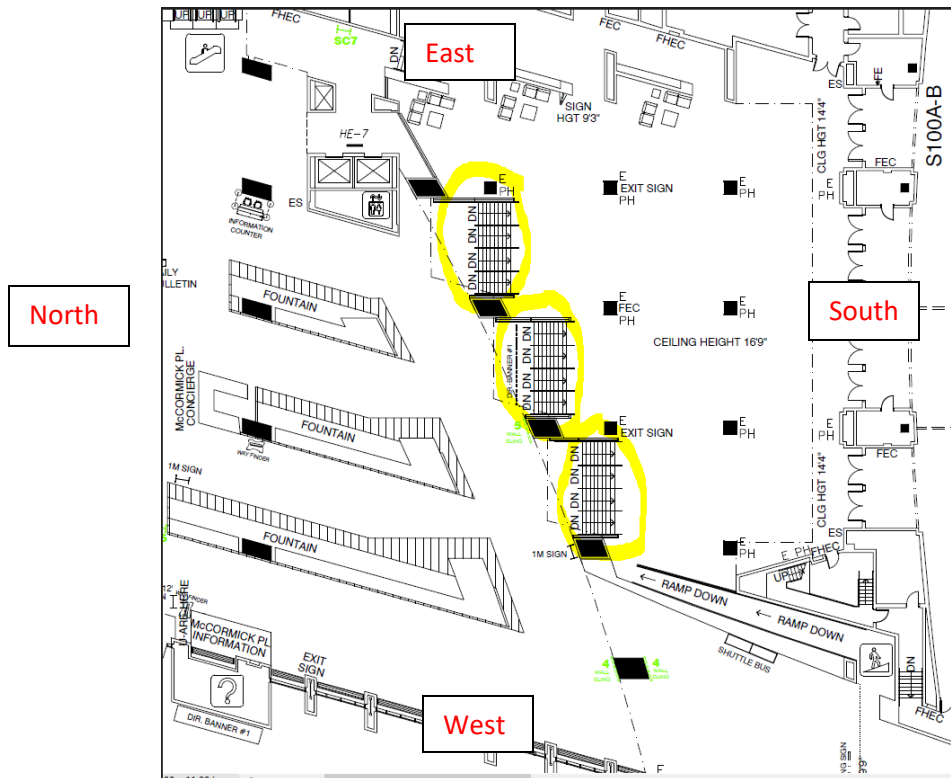

Specs continue on the following pages

West Stairs (Left side when facing stairs):

9 Stairs

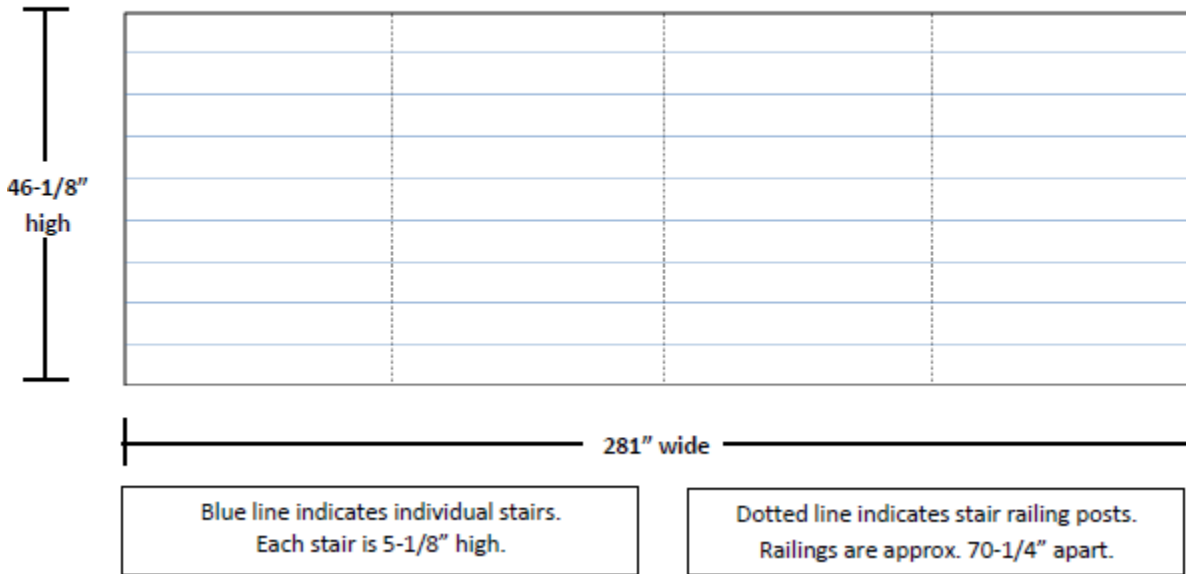

Center Stairs:

9 Stairs

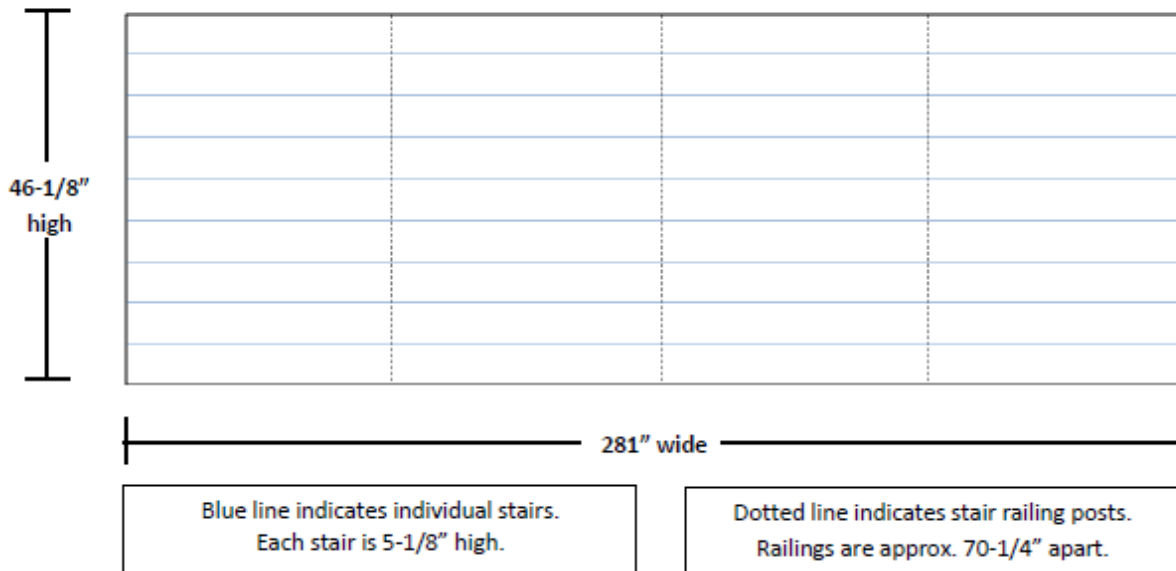

East Stairs (Right side when facing stairs):

9 Stairs

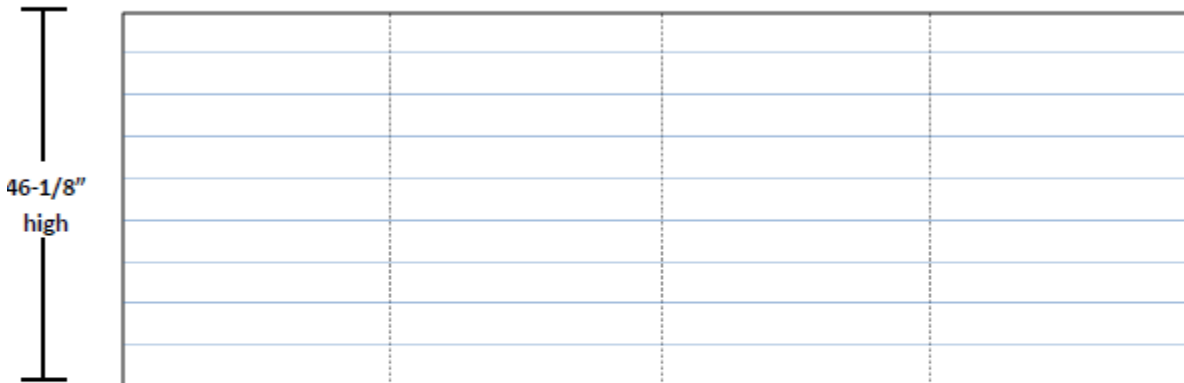

281" wide

Blue line indicates individual stairs.
Each stair is 5-1/8" high.

Dotted line indicates stair railing posts.
Railings are approx. 70-1/4" apart.